

PAGE 1/3

ISSUE 23-02-18A

SERIES SMA

PART NUMBER R125061027

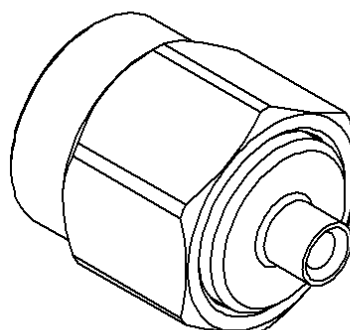
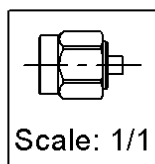
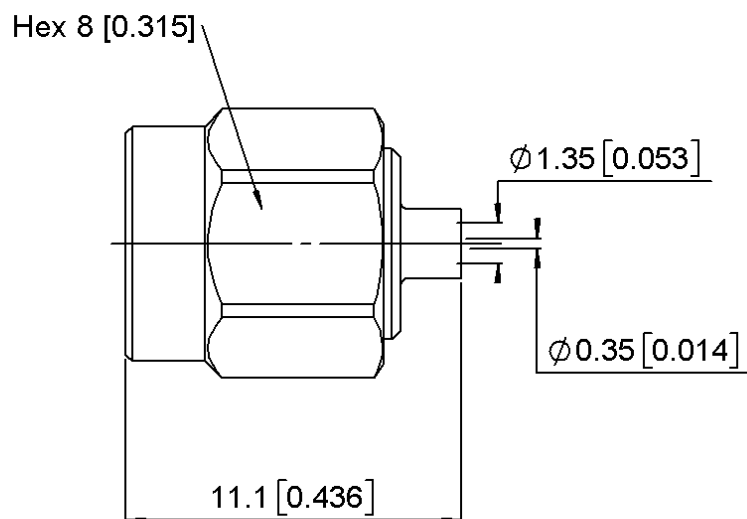

All dimensions are in mm. Tolerances according ISO 2768 m-H

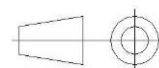

COMPONENTS	MATERIALS	PLATING (µm)
Body	BERYLLIUM COPPER	BBR
Center contact	BERYLLIUM COPPER	GOLD OVER COPPER
Outer contact		
Insulator	PTFE	
Gasket	SILICONE RUBBER	
Others parts	BERYLLIUM COPPER	BBR
-	-	-
-	-	-

PAGE **2/3**

ISSUE **23-02-18A**

SERIES **SMA**

PART NUMBER **R125061027**

PACKAGING

Standard	Unit	Other
100	Contact us	Contact us

ELECTRICAL CHARACTERISTICS

Impedance	50	Ω
Frequency	0-18	GHz
VSWR	1.07 + 0.0080	x F(GHz) Maxi
Insertion loss	0.03	\sqrt{F} (GHz) dB Maxi
RF leakage	- (90)	- F(GHz)) dB Maxi
Voltage rating	335	Veff Maxi
Dielectric withstanding voltage	750	Veff mini
Insulation resistance	5000	M Ω mini

MECHANICAL CHARACTERISTICS

Center contact retention		
Axial force – Mating End	N/A	N mini
Axial force – Opposite end	N/A	N mini
Torque	N/A	N.cm mini
Recommended torque		
Mating	100	N.cm
Panel nut	N/A	N.cm
Clamp nut	N/A	N.cm
A/F clamp nut	0.0000	mm
Mating life	500	Cycles mini
Weight	2.3300	g

ENVIRONMENTAL

Operating temperature	-65/+165	°C
Hermetic seal	N/A	Atm.cm3/s
Panel leakage	N/A	

SPECIFICATION

CABLE ASSEMBLY

Stripping	a	b	c	d	e	f
mm	3.17	0	0	0	0	0

Assembly instruction:

Recommended cable(s)

0.047 NON-MAGNETIC

Characteristics indicated on this data sheet are those that can be achieved with the highest performance cable. Intrinsic limitations of the cable may diminish the performance of the assembly

Cable retention

- pull off	45	N mini
- torque	N/A	N.cm

TOOLING

Part Number	Description	Hexagon
R282730040	INSULATOR MOUNTING TOOL	
R282744220	SOLDERING POSITIONER(CENTER CONTACT)	
R282857000	CONTROLE GAUGE	
R282862060	CONTROL GAUGE	
R282740000	SOLDERING MOUNTING	

OTHER CHARACTERISTICS

**DISTORTION OF MAGNETIC FIELD <0.5ppm
AT Bo=1.5 TESLA**

COMPONENTS

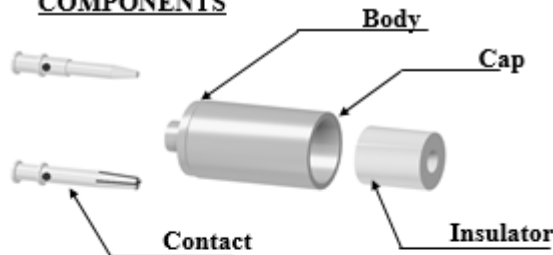

STRIPPING DIMENSIONS



1

Strip the cable .
Trim the cable inner conductor .
Clean the cable.



3

After cooling, remove the assembly from the jig.
Screw the positioner B onto the assembly jig.
Slide the cable into the connector until it bottoms against the positioner B.
Tighten.
Put three rings of solder around the cable and solder.

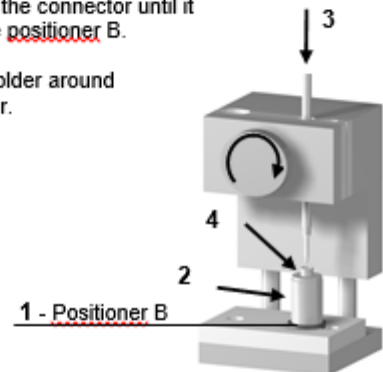

2

Mount the positioner A.
Slide the centre contact into the positioner A.
Insert the solder gauge between the centre contact and the cable.
Tighten.
Solder the centre contact.

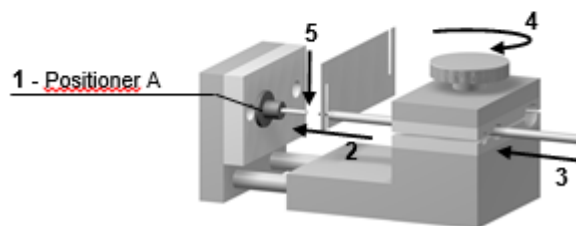

4

Screw dielectric insert tool onto the connector and insert the insulator with the dielectric plunger.

